

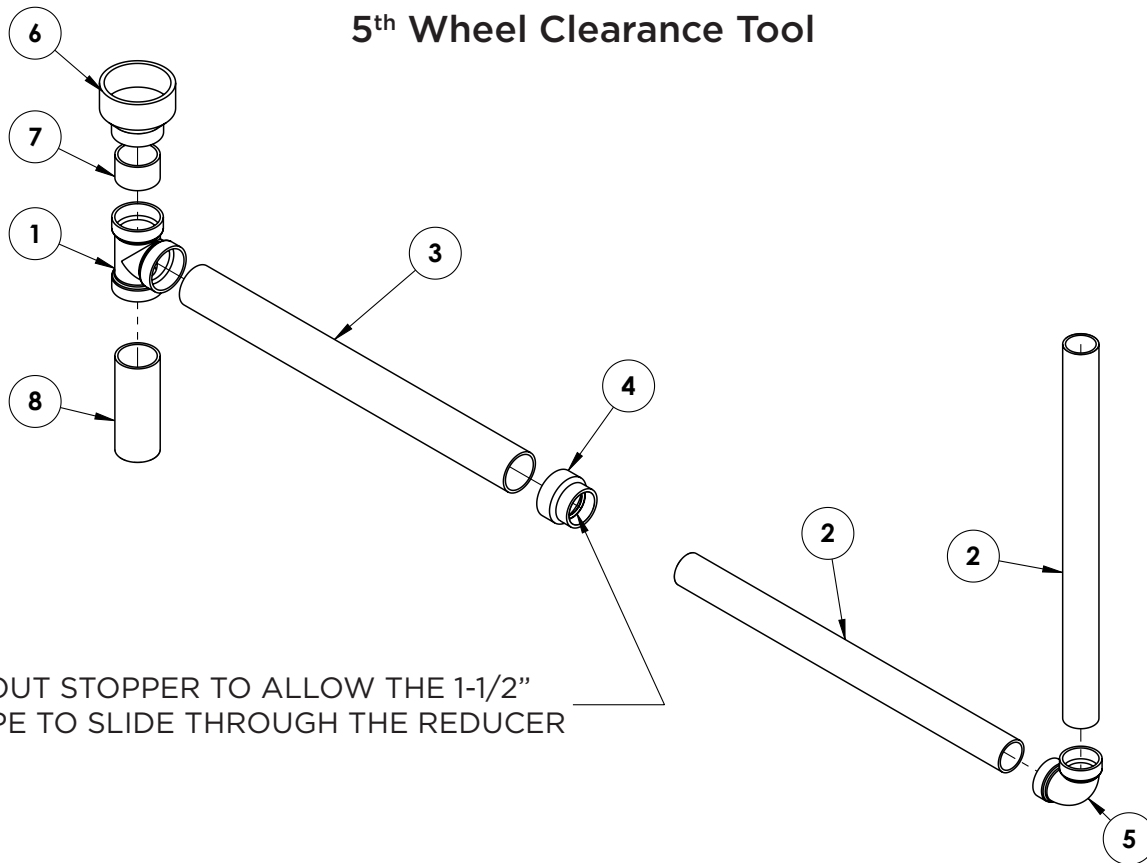

# Technical/Service Bulletin

Log Number: SB043  
 Subject: Measuring 5th Wheel Clearance  
 To: Valued Blue Ox Dealers & Distributors  
 Date: January 30<sup>th</sup>, 2023



**INSTRUCTIONS:**

PVC GLUE ALL JOINTS TOGETHER EXCEPT ITEM #4 TO ITEM #2,  
 ITEM #2 SHOULD SLIDE FREELY INSIDE ITEM #4 FOR ADJUSTMENT

Item No.	Description	Qty.
1	2" PVC Tee Connector	1
2	1-1/2" x 24" Long PVC Pipe	2
3	2" x 24" Long PVC Pipe	1
4	2" to 1-1/2" PVC Reducer	1
5	1-1/2" PVC 90° Connector	1
6	3" to 2" PVC Reducer	1
7	2" x 1-1/2" Long PVC Pipe	1
8	2" x 6" Long PVC Pipe	1

## Measuring 5<sup>th</sup> Wheel Clearance



1. Position tool above the center of the 5<sup>th</sup> Wheel Hitch.



2. Keeping tool centered on the hitch, extend the arm of the tool till the end touched the back of the truck cab. Mark arm at this length.



3. Place the top of the tool over the king pin on the 5<sup>th</sup> wheel trailer.



4. Rotate tool so that it is at a 90° angle form the king pin. If the tool does not hit the front of the 5<sup>th</sup> wheel trailer there is enough clearance.  
**Note:** Be aware of the bubble on the front of the 5<sup>th</sup> wheel, this may or may not affect clearance depending on the height of the truck cab.